



**Potts Point, NSW**  
15/20-22 Springfield Avenue

**0**  
BED

**1**  
BATH

**0**  
CAR

**LAING**

### 'Sandringham'

- North facing Strata Studio with pleasant garden outlook.
- Modern kitchen and bathroom plus internal laundry.
- Ready to move in or rent out.
- Striking Deco building with many period features.
- Convenient location close to public transport and a wide array of shops.
- Enjoy the many choices of casual through to formal dining venues nearby.

**\$495,000 ONO**

**Council Rates:** \$1,108/year (approx)

**Water Rates:** \$741/year (approx)

**Strata Fees:** \$5,953/year (approx)

**Contact:** Tony Dowling  
0411 402 531

**Type:** Studio

<http://www.laing.com.au>

Inspect: As Advertised or By Appointment

Details: Tony Dowling

0411 402 531

tony@laing.com.au

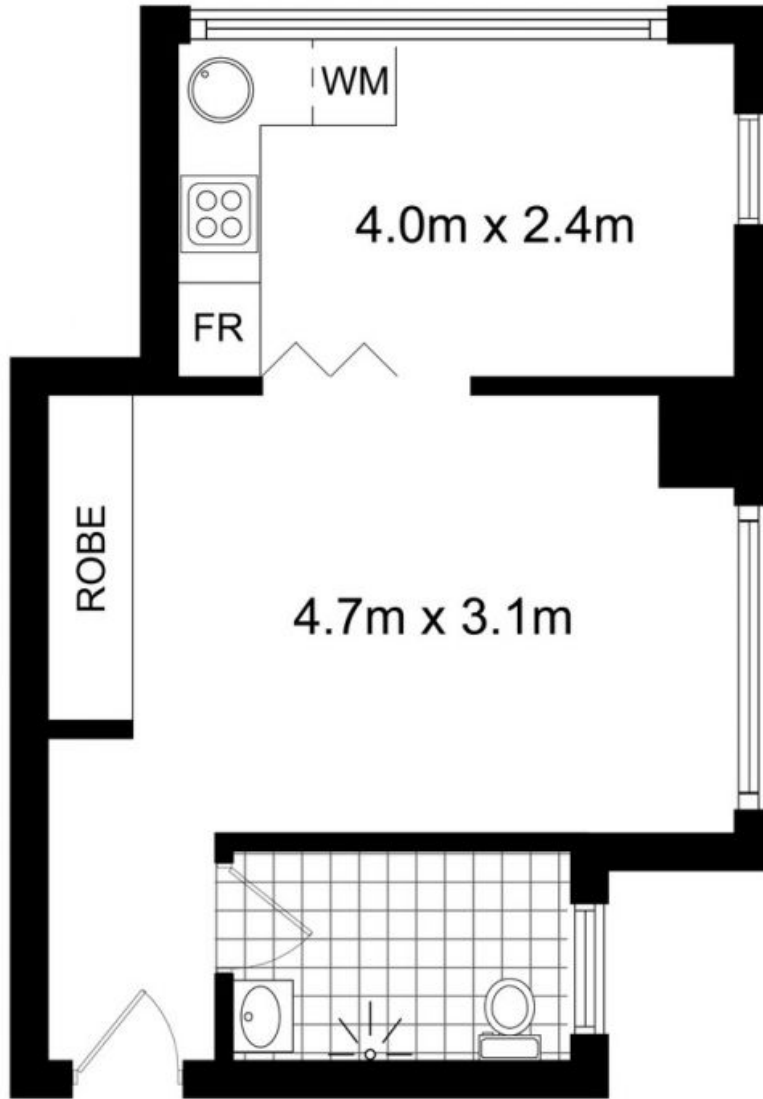

**LEVEL ONE**



15/20-22 SPRINGFIELD AVENUE,  
POTTS POINT

DISCLAIMER: WE HAVE OBTAINED ALL INFORMATION IN THIS DOCUMENT FROM SOURCES WE BELIEVE TO BE RELIABLE; HOWEVER, WE CANNOT GUARANTEE ITS ACCURACY. PROSPECTIVE PURCHASERS ARE ADVISED TO CARRY OUT THEIR OWN INVESTIGATIONS

Plans shown are only indicative of layout. Dimensions are approximate.

**Potts Point, NSW**  
15/20-22 Springfield Avenue