



Elizabeth Bay, NSW

2/8 Greenknowe Avenue

1
BED

1
BATH

0
CAR



LAING

SOLD PRIOR TO AUCTION BY SIMON POLITO & MATTHEW ALLERTON

SOLD PRIOR TO AUCTION BY SIMON POLITO & MATTHEW ALLERTON

Spacious internal living area and a generous alfresco entertainment terrace defines this loft style apartment in Manhattan'.

The northeast facing living and dining area is flooded with natural light with its double height windows. Modern timber panelled kitchen with Miele appliances is ideal for entertaining. Convenience of an internal laundry cupboard.

The upper level houses a generous sized bedroom with walk in robe, adjacent is the marble bathroom.

Ideally positioned moments to the heart of Potts Point's restaurants, cafes and shopping hub.

SOLD

Council Rates: \$944/year (approx)

Water Rates: \$652/year (approx)

Strata Fees: \$3,306/year (approx)

Contact: Vicki Laing
0411 88 77 60

Type: Apartment

Sold Date: 17/09/2015

<https://www.laing.com.au>

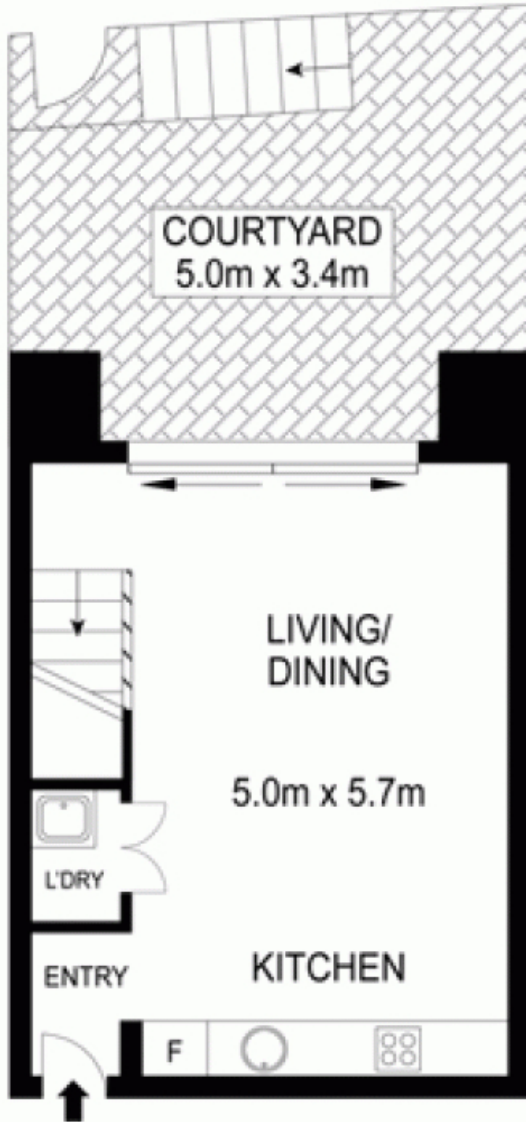

ENTRY LEVEL

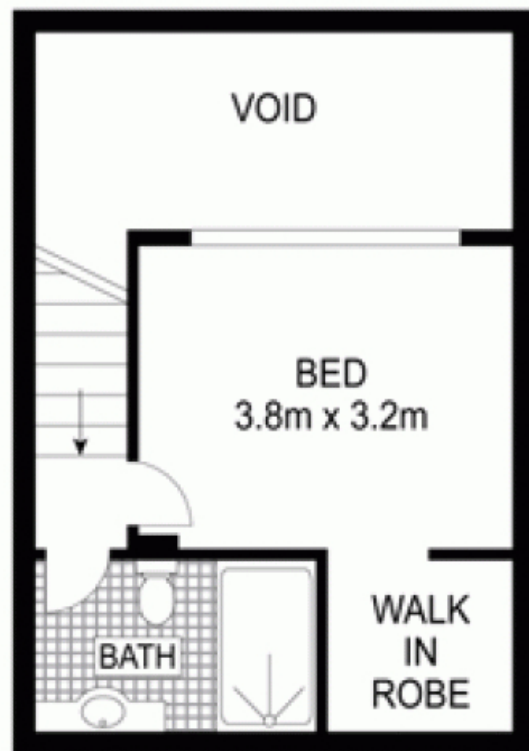

LEVEL ONE



Scale in metres. Indicative only. Dimensions are approximate. All information contained herein is gathered from sources we believe to be reliable. However we cannot guarantee its accuracy and interested persons should rely on their own enquiries.



2/8 Greenknowe Avenue, Elizabeth Bay

Plans shown are only indicative of layout. Dimensions are approximate.

Elizabeth Bay, NSW
2/8 Greenknowe Avenue